



**PANEL & ENGINEERED
LUMBER INTERNATIONAL
CONFERENCE & EXPO**

EXHIBITOR LIST

Exhibit Hall 100-525 • Atrium Level 600-707

ACROWOOD
102

ACS HYDRAULICS
703

ALABAMA POWER
211, 213

ANDRITZ
104

ARCH WOOD PROTECTION
705

ARCLIN
314

AUTOMATION INDUSTRIES
403

BRUKS KLOCKNER
203

BURKLE NORTH AMERICA
508

CECO ABATEMENT
501,503

CERAM/LEXCO
525

CON-VEY KEYSTONE
109

CONCEPT SYSTEMS
701

CUSTOM ENGINEERING
207

DIEFFENBACHER
401

DRYING TECHNOLOGY
404

DURR SYSTEMS INC., EES
105

**ELECTRONIC WOOD
SYSTEMS NA**
309

EUROSOFT
402

EVERGREEN ENGINEERING
414

FLAMEX
419

FLASHCHEM
602

FLIR SYSTEMS
514

GEOENERGY
319

**GEORGIA DEPT. OF
ECONOMIC DEVELOPMENT**
415

**GEORGIA FORESTRY
COMMISSION**
417

GIBEN INTERNATIONAL
405

GLOBE MACHINE
303

GRECON
511

GRENZEBACH
517

**HARDWOOD PLYWOOD
& VENEER ASSN.**
315

HERCULES
412

HERMES ABRASIVES
515

**HEXION SPECIALTY
CHEMICAL**
100

**HUNT GUILLOT
& ASSOCIATES**
306,308

HUNTSMAN
106

HYMMEN
312

INTERWRAP
601

ITIPACK SYSTEMS
202

**ITS AUTOMATION
& CONTROLS**
311

JER ENVIROTECH
611

KIMWOOD
408

KLINGSPOR ABRASIVES
418

KOCH KNIGHT
518

LAIDIG SYSTEMS
516

LP BUILDING PRODUCTS
608

MCGILL AIR CLEAN
201

MEGTEC
406

MEREEN JOHNSON
604

METRIGUARD
101

MID-SOUTH ENGINEERING
209

**PALLMANN
MASCHINENFABRIK**
420

PAUL SAWS
510

PENTEC INTERNATIONAL
605

PERFOREX
313

PRO-ENVIRONMENTAL
411

PROCESS SENSORS
600

RAUTE CANADA
305, 307

SAINT-GOBAIN ABRASIVES
409

SAMUEL STRAPPING
410

SANDVIK
103

SCHELLING AMERICA
523

SEARCH NORTH AMERICA
107

SENSORTECH SYSTEMS
513

SIEMPELKAMP
310

SIGNODE
502

STANDEX
603

STANTEC
512

**STEINEMANN
TECHNOLOGY**
509

**SUD-CHEMIE AIR
PURIFICATION**
610

SUN ABRASIVES
505

TSI
413

TECO
302, 304

THE TEAFORD CO.
301

**TIMBER PRODUCTS
INSPECTION**
607

**TOTAL PRODUCTIVE
MAINTENANCE**
606

TRI-MER
407

TURBOSONIC
507

**US FOREST PRODUCTS
LABORATORY**
317

VENANGO MACHINE
205

VENTEK
521

**WECHSLER ENGINEERING
& CONSULTING**
519

WEST SALEM MACHINERY
504

WESTMILL INDUSTRIES
416

WILLAMETTE VALLEY
506

WOODSMART SOLUTIONS
702

WPS INDUSTRIES
609

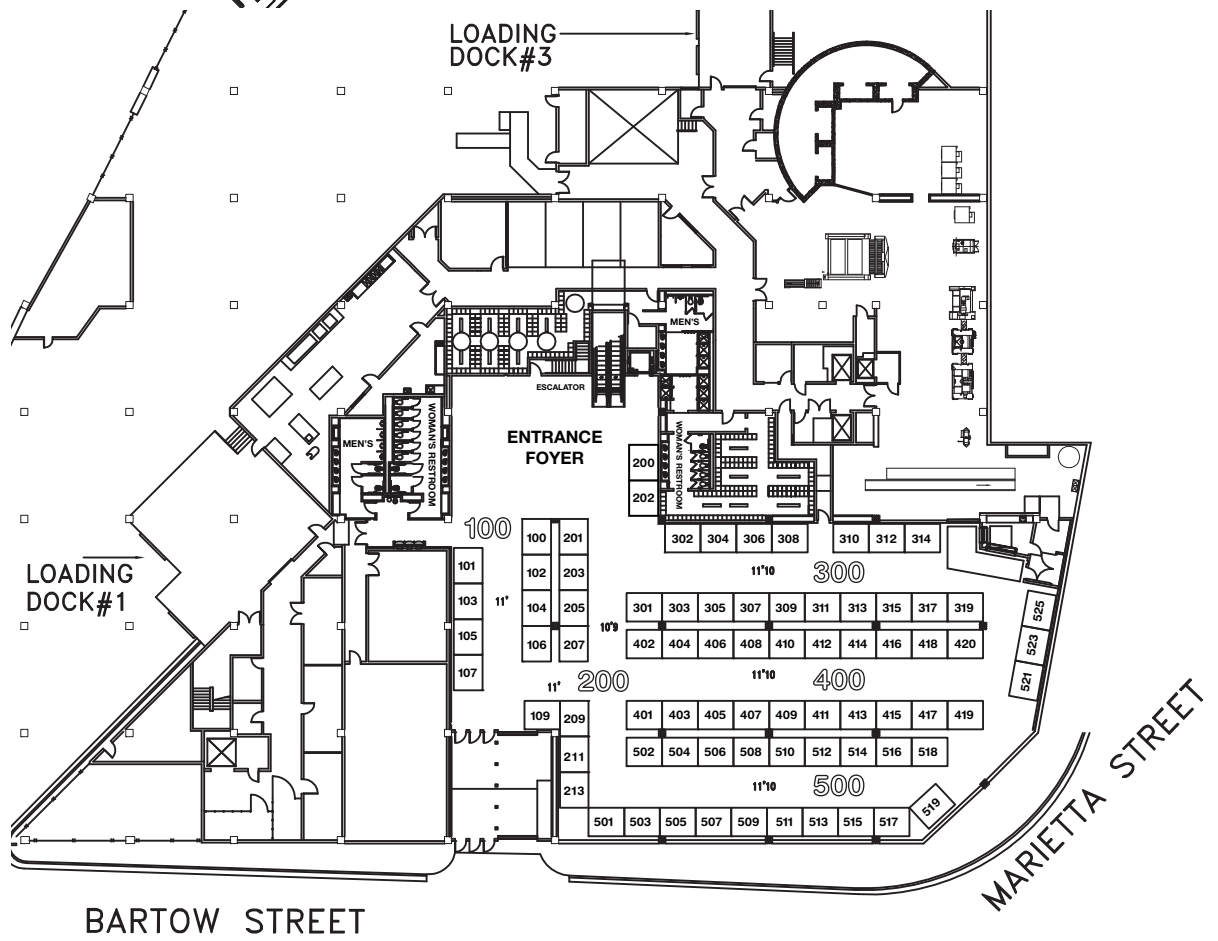
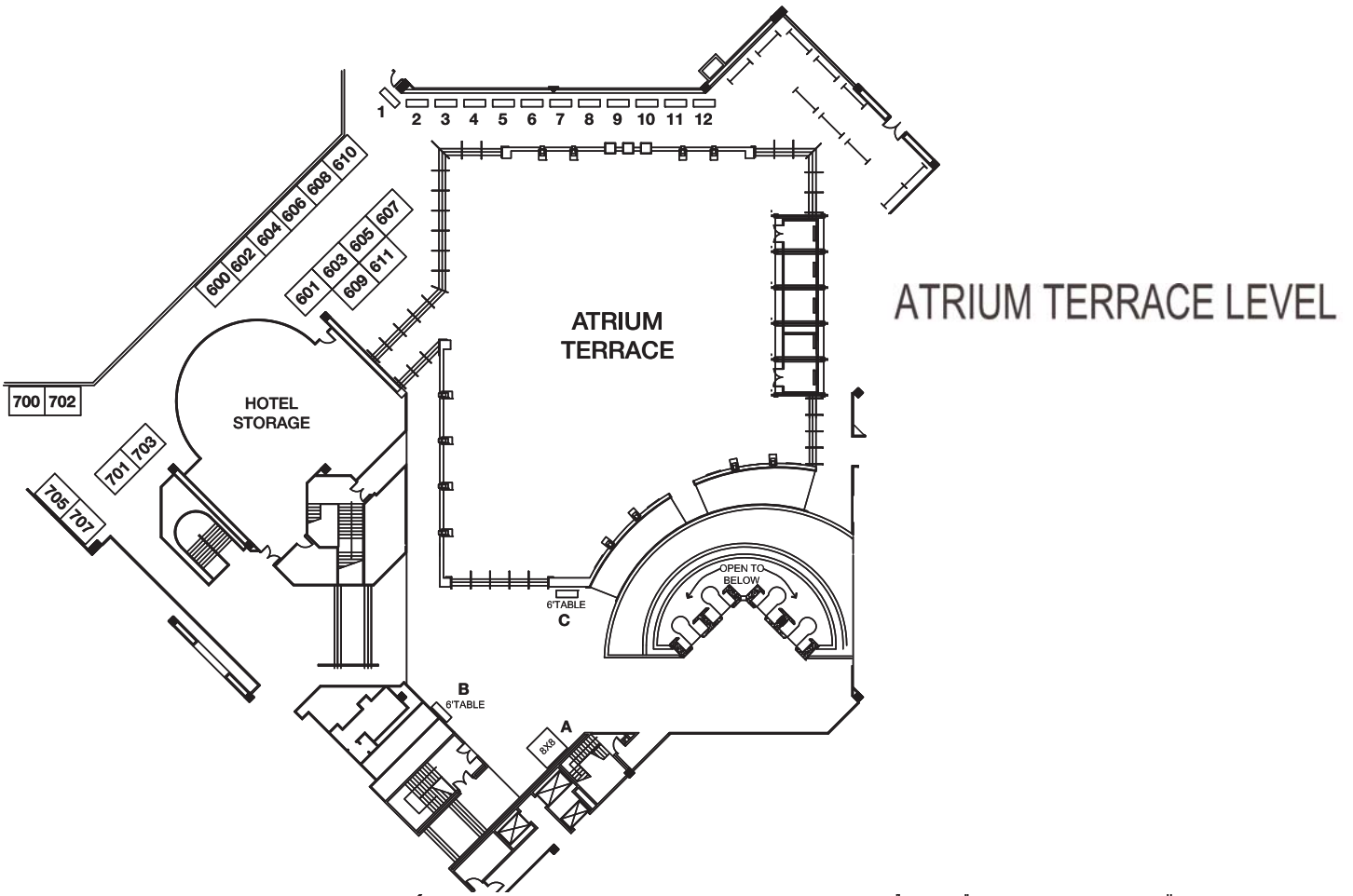

BARTOW STREET

SOUTH LEVEL - EXHIBIT HALL